

TENSIONING FORM FINISHER

MOD 2060

Automatic tensioning form finisher for ironing men's or women's jackets and overcoats, or wool garments, extremely compact in size.

Features and strengths

- Time switch programmed through digital electronic control panel, steaming brush/iron
- Pivoting control board
- 10 different work programs to perform all kind of garments and size
- Automatic or manual operation
- Vertical and horizontal garment tensioning for perfect finishing
- Adjustable shoulders
- Automatic size adjustment
- Strong ventilation unit with air-regulation

Options

- All steam irons



TYPE		MOD 2060
ELECTRIC CONNECTIONS		
Standard voltage 400 V / 3 Ph / 50 Hz	kW	3
Other voltages available on request		
Vacuum motor power	kW	1,1
Super heating device	kW	1
STEAM AND AIR CONNECTIONS		
Steam inlet	inch	1/2"
Steam outlet	inch	1/2"
Steam supply	kPa	400 - 600
Steam supply	bar	6
Steam consumption	kg/h	15 - 20
Compressed air inlet	inch	1/4"
Compressed air supply	kPa	600 - 800
Compressed air supply	bar	6
SHIPPING DATA		
Packing type		Pallet + carton box
Shipping dimensions	mm	1000 x 900 x 1600
Net weight	kg	180
Gross weight	kg	200

TOP VIEW

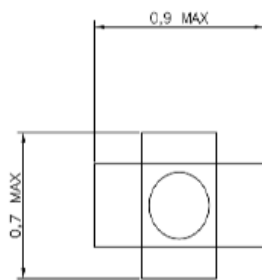

REAR VIEW

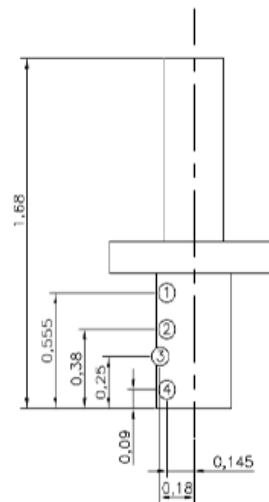

4	ELECTRIC POWER	--
3	AIR INLET	Ø 8 mm
2	CONDENSATION RETURN	1/2" F
1	STEAM	1/2" F