

## SEMI AUTOMATIC SHIRTS FINISHER - 40 pcs/h

### MOD SR 1000 V

**The true alternative for quality and productivity in the finishing of ironing men's or women's shirts, smocks, doctor's suit, jackets and overcoats.**

#### Features and strengths

- Strong and complete steam distribution, moistens the fabric to remove creases
- Hot air blowing presses and dries the fabric
- Front and rear paddle to hold the garment in place
- Time switch programmed through digital electronic control panel
- Automatic stretching ahead and upright of the arms and clamps
- Return and sleeve stretching by air operated regulation
- Adjustable air blowing to comply at garment variety
- Supplied with a pair of sleeves and clamps
- Built-in vacuum motor for simply installation
- For shirts, jacket and doctor suits processing
- Productivity 40 pcs/h
- Super heating device

#### Options

- Water spray gun



TYPE		MOD SR 1000V
<b>ELECTRIC CONNECTIONS</b>		
Standard voltage 400 V / 3 Ph / 50 Hz	kW	4
Other voltages available on request		
Vacuum motor power	kW	2,2
Super heating device	kW	
<b>STEAM AND AIR CONNECTIONS</b>		
Steam inlet	inch	1/2"
Steam outlet	inch	1/2"
Steam supply	kPa	400 - 600
Steam supply	bar	6
Steam consumption	kg/h	25 - 30
Compressed air inlet	inch	1/4"
Compressed air supply	kPa	600 - 800
Compressed air supply	bar	6
<b>SHIPPING DETAILS</b>		
Packing type		Pallet + carton box
Shipping dimensions		1500 x 1000 x 2000
Net weight	kg	200
Gross weight	kg	250

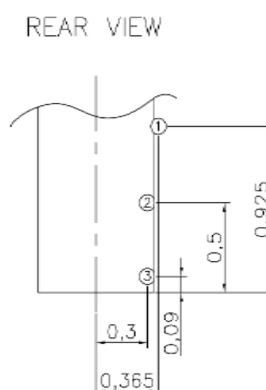
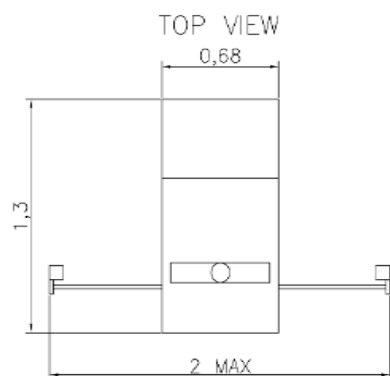

3	CONDENSATION RETURN	1/2" F
2	STEAM	1/2" F
1	AIR INLET	Ø 8 mm